

**First Alert Security System**

---

N4861-1V4 11/93

**First  
Alert**  
PROFESSIONAL  
SECURITY SYSTEMS

# TABLE OF CONTENTS

---

SYSTEM OVERVIEW .....	4
Keypads.....	4
Zones.....	4
Fire Protection .....	5
Burglary Protection.....	5
Alarms .....	5
ABOUT THE KEYPADS .....	6
SUMMARY OF KEYPAD FUNCTIONS .....	8
Fixed-Word Keypad–Window Displays.....	10
ENTRY/EXT DELAYS .....	11
SECURITY CODES .....	12
User Codes.....	12
Duress Code .....	12
Quick Arming.....	13
To Assign and Delete User Codes .....	13
CHECKING FOR OPEN ZONES.....	14
BYPASSING PROTECTION ZONES.....	16
Displaying Bypassed Protection Zones.....	16
ARMING PERIMETER ONLY (With Entry Delay On).....	18
ARMING PERIMETER ONLY (With Entry Delay Off).....	20
ARMING ALL PROTECTION (With Entry Delay On).....	22
ARMING ALL PROTECTION (With Entry Delay Off).....	24
DISARMING THE SYSTEM AND SILENCING ALARMS .....	26

---

# TABLE OF CONTENTS

CHIME MODE .....	27
DURESS CODE .....	28
PANIC (EMERGENCY) KEYS .....	29
TESTING THE SYSTEM .....	30
TROUBLE CONDITIONS .....	32
FIRE ALARM SYSTEM (If Installed).....	34
In Case Of Fire Alarm .....	34
Silencing Fire Alarms .....	35
NATIONAL FIRE PROTECTION ASSN. RECOMMENDATIONS.....	36
EMERGENCY EVACUATION .....	37
SUMMARY OF AUDIBLE SOUNDS AND DISPLAYS.....	38
PROTECTION ZONES.....	39
QUICK REFERENCE OPERATING GUIDE .....	40
MAINTAINING YOUR SYSTEM .....	41
FCC STATEMENTS, PART 15 and PART 68.....	42, 43
CANADIAN DEPARTMENT OF COMMUNICATIONS (DOC) STATEMENT.....	44
OWNER'S INSURANCE PREMIUM CREDIT REQUEST FORM .....	45
THE LIMITATIONS OF THIS ALARM SYSTEM .....	47
WARRANTY .....	49
IN THE EVENT OF TROUBLE WITH YOUR REGULAR TELEPHONE SERVICE.....	50
SERVICING INFORMATION.....	51

# SYSTEM OVERVIEW

---

## General

Congratulations on your ownership of a First Alert Professional Security System. You've made a wise decision in choosing it, for it represents the latest in security protection technology today, including microcomputer technology to monitor system status at all times.

Basically, this system offers you three forms of protection – burglary, fire and emergency. Your system consists of at least one Keypad which provides full control of system operation, plus various devices such as door and window sensors and motion detectors. It may also include a selected number of smoke or combustion detectors designed to provide early warning in case of fire.

## Keypads

Your keypads allow you to control all system functions, and feature a telephone style (digital) keypad, a Liquid Crystal Display (LCD) that shows the nature and location of all occurrences, and a built-in sounder which sounds during alarms and troubles. Your System uses Fixed-Word Display keypads (see *ABOUT THE KEYPADS*).

## Zones

Your system's sensing devices have been assigned to various "zones". For example, the sensing device on your Entry/Exit door may have been assigned to zone 01, sensing devices on windows in the master bedroom to zone 02, and so on. These zone numbers will appear on the keypad display when an alarm or trouble condition occurs.

---

# SYSTEM OVERVIEW

## Fire Protection

The fire protection portion of your security system (if used) is always on, and sounds an alarm if a fire condition is detected. Refer to the *FIRE ALARM SYSTEM* section for important information concerning fire protection, smoke detectors and planning emergency exit routes.

## Burglary Protection

The burglary protection portion of your system must be turned on or "armed" before it can sense burglary alarm conditions and sound an alarm. Your system can be armed in one of four modes: *STAY*, *AWAY*, *INSTANT* and *MAXIMUM*. Refer to the *ARMING* sections for instructions in using these modes of operation. The principal differences between these four arming modes will be seen in the chart below.

SUMMARY OF ARMING MODES

<i>Arming</i>	<i>Features For Each Arming Mode</i>			
<i>Mode</i>	<i>Exit Delay</i>	<i>Entry Delay</i>	<i>Perimeter Armed</i>	<i>Interior Armed</i>
<i>AWAY</i>	Yes	Yes	Yes	Yes
<i>STAY</i>	Yes	Yes	Yes	No
<i>INSTANT</i>	Yes	No	Yes	No
<i>MAXIMUM</i>	Yes	No	Yes	Yes

## Alarms

When an alarm occurs, both the keypad and external sounders sound, and the keypad displays the zone(s) causing the alarm. If your system is connected to a central monitoring station, an alarm message is also sent. To stop the alarm sounding, simply disarm the system.

## **ABOUT THE KEYPADS**

---

### **General**

The type of keypad used in your system is known as a **FIXED-WORD** keypad. This type features a multifunction, backlit 12-key digital keypad, and a Liquid Crystal Display (LCD) that uses pre-designated fixed words to identify the nature and location of all occurrences. A built-in sounder emits alarm sounds during alarm conditions, and produces warning tones during entry and exit delay periods. This sounder also provides acknowledgment tones when keys are pressed, and confirmation tones for successful command entries.

Fixed-Word keypads are available in two styles, A and B, either of which may have been used in your system. Although different in appearance, both styles are functionally the same. The keypads on style B keypads are located behind a flip-down cover which can be removed, if desired. Message displays on all Fixed-Word keypads are the same, except that the location of words in the display window will differ slightly with each style. Both styles of keypads are shown on the next page.

The style B keypad, with appropriate message displays, is depicted in the instructions throughout this manual.

Unless noted otherwise, all procedures in this manual apply equally to both keypad styles.

# ABOUT THE KEYPADS

## STYLE A KEYPADS

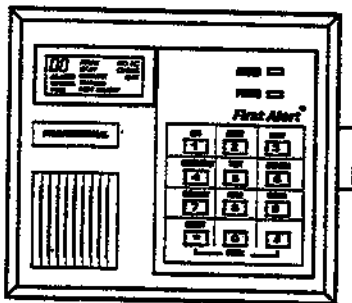

FA200KP

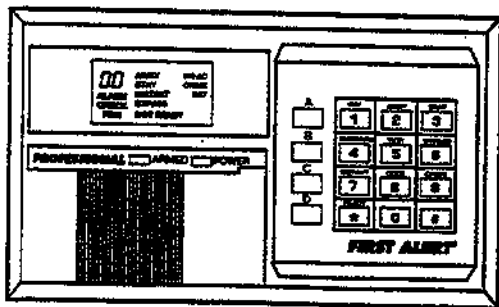

FA310KP

## STYLE B KEYPAD

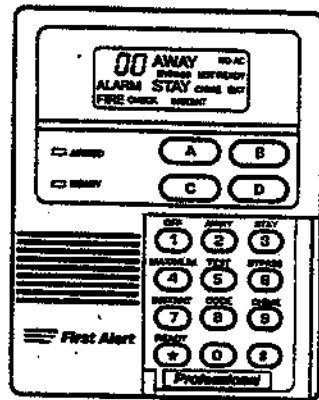

FA250KP

(SHOWN WITH KEYPAD COVER REMOVED)

## SUMMARY OF KEYPAD FUNCTIONS

- 1. DISPLAY WINDOW:** The Fixed-Word Keypad features a Liquid Crystal Display (LCD) that displays protection point identification and system status, messages. See the *FIXED WORD KEYPAD-SYSTEM STATUS DISPLAYS* on page 10 for Fixed-Word Display messages and their meanings.
- 2. 1 OFF KEY:** Used to disarm the burglary portion of the system, silence alarms and audible trouble indicators, and clear visual displays after a problem has been corrected.
- 3. 2 AWAY KEY:** Used to arm the entire burglary system, perimeter and interior.
- 4. 3 STAY KEY:** Used to arm the perimeter portion of the burglary system only. Interior protection is not armed, which allows movement within your house without causing an alarm.
- 5. 4 MAXIMUM KEY:** Used to arm in manner similar to AWAY mode, but without the entry delay feature, thus providing maximum protection. An alarm will occur immediately upon opening any protection point, including an Entry/Exit door.
- 6. 5 TEST KEY:** Tests the system and alarm sounder if disarmed. Refer to the TESTING THE SYSTEM section for test procedures.
- 7. 6 BYPASS KEY:** Removes individual protection zones from being monitored by the system.
- 8. 7 INSTANT KEY:** Arms in manner similar to STAY mode, but without the entry delay feature. Opening an Entry/Exit door will cause an instant alarm.
- 9. 8 CODE KEY:** Used to assign additional use codes that can be given to other users of the system.
- 10. 9 CHIME KEY:** Used to turn CHIME mode on and off. When on, the opening of window and doors will produce three tones at the Keypad(s).
- 11. \* READY KEY:** Used to display all open protection zones. Hold down for a few seconds to activate.
- 12. # KEY:** "Quick Arm" key permits ARMING of the system without use of a security code (if programmed to do so).
- 13. KEYS 0-9:** Used to enter your security code(s).

**Important!:** When entering codes and commands, sequential key depressions must be made within 3 seconds of one another. If 3 seconds elapses without a key depression, the entry is aborted and must be repeated from its beginning.



14. **READY INDICATOR: (GREEN)** Lit when system is ready for arming (no protection zones open). When the system is disarmed, this indicator will go on and off as protection zones are opened and closed.

*Note:* On some keypads (style A), a **POWER** indicator is provided instead, which when on, indicates that AC power is present, and when off, indicates that AC has been cut off and that the system is operating on the back-up battery.

15. **ARMED INDICATOR: (RED)** Lit when the system has been armed (STAY, AWAY, INSTANT or MAXIMUM).
16. **INTERNAL SOUNDER:** The built-in keypad sounder provides alarm sounds during alarms, and also emits tones during certain system functions. (see *SUMMARY OF AUDIBLE SOUNDS AND DISPLAYS*).
17. **EMERGENCY KEYS B, & C:** (keys A & D not active). May be programmed for panic functions by your installer (see page 29).  
On some keypads, individual emergency keys B and C are not present. In those cases, the following key pairs are used for emergency:

[\*] and [#]  
[#] and [3]

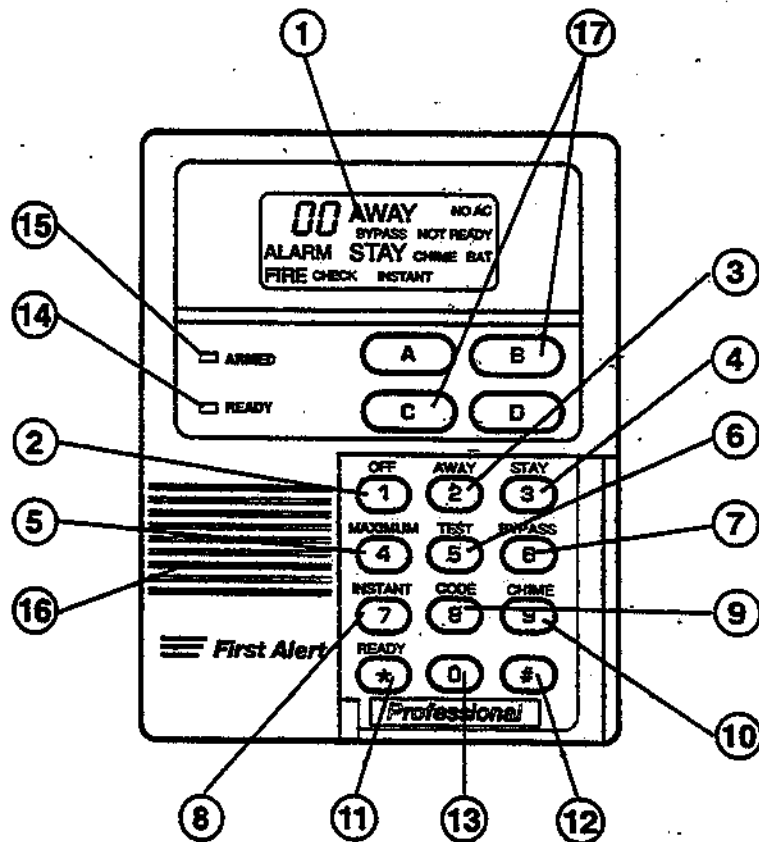

Style B Fixed-Word Keypad shown above.

## FIXED-WORD KEYPAD - WINDOW DISPLAYS

<b>AWAY</b>	All burglary zones, interior & perimeter, are armed.
<b>STAY</b>	Perimeter burglary zones, such as windows and doors, are armed.
<b>INSTANT</b>	Perimeter burglary zones armed and entry delay is turned off.
<b>BYPASS</b>	One or more burglary protection zones have been bypassed.
<b>NOT READY</b>	Appears when the burglary system is not ready for arming (due to open zones).
<b>READY</b>	The burglary portion of the system is ready to arm.
<b>NO AC</b>	Appears when AC power has been cut off.
<b>AC</b>	Appears when AC power is present.
<b>CHIME</b>	Appears when the CHIME feature is ON.
<b>BAT</b>	With no zone # present, indicates low system battery; with zone #, low wireless transmitter battery.
<b>ALARM</b>	Appears when an intrusion has been detected and the system is armed (also appears during a Fire alarm). Accompanied by the ID # of zone in alarm.
<b>CHECK</b>	Appears whenever a malfunction is present, or whenever there is a fault in a FIRE zone, or in a 24-hour burglary zone during a disarmed period. Accompanied by a display of zone number in trouble.
<b>FIRE</b>	Appears when a fire alarm is present. Accompanied by a display of the zone # in alarm.

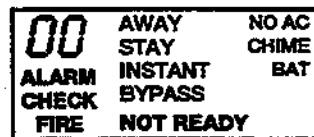

STYLE "A" FIXED-WORD KEYPAD WINDOW DISPLAY



STYLE "B" FIXED-WORD KEYPAD WINDOW DISPLAY

# ENTRY/EXIT DELAYS

## General Information

Your system has preset time delays, known as an exit delay and an entry delay. When you arm your system, the **exit delay** gives you time to leave through an entry/exit door without setting off an alarm. The **Entry delay** gives you time to disarm the system when you re-enter through an entry/exit door. But the system must be disarmed before the entry delay period ends, or an alarm will occur. The keypad will emit tones during the entry delay period, reminding you to disarm the system. You can also arm the system with no entry delay at all by using either INSTANT or MAXIMUM arming modes. These modes can provide greater security when sleeping or while away for extended periods of time. See your installer for your delay times, which should be entered below.

### ENTRY/EXIT TIMES

Exit Delay

seconds

*Location*

Entry Delay

seconds

# SECURITY CODES

---

**General** At the time of installation, your installer programmed a personal four-digit "master" code, known only to you and yours. This code is used to perform most system functions, including arming and disarming of the system.

**User Codes** As an additional safety feature, up to 6 temporary user codes can be assigned for use by those not having a need to know the master code. Temporary codes are assigned "user numbers," to identify the users of each code. Note that the master code remains in effect even though other user codes are assigned.

**Duress Code** This feature is intended for use when you are forced to disarm or arm the system under threat. When used, the system will act normally, but can silently notify the central station of your situation, if that service has been provided. The duress code is the same as your user code, except that the last digit is increased by one. For example, if the normal security code is "1 2 3 4", the duress code is "1 2 3 5". User codes that end in "9" (e.g., 6349) cannot activate a duress alarm (i.e., 6350 is not a duress alarm).

**Important:** *This code is useful only when connected to a central alarm monitoring station.*

# SECURITY CODES

## Quick Arming

If your system supports "Quick Arming", the [#] key can be pressed in place of the security code when arming the system (check with your installer). The security code is *always* required when disarming the system, however.

## To Assign or Delete User Codes

Up to 6 temporary User codes (3-8) can be assigned by User 2 (the Master User).

It is recommended that obvious codes such as 1111 or 1234 not be assigned.

### Procedure:

1. Enter your Master code and press the **CODE** key.
2. Enter User Number to be assigned or deleted (3-8).
3. Enter the 4-digit temporary code for that User Number. The keypad will emit a single tone if completed successfully.

If deleting a user's code, perform steps 1 & 2 and re-enter the Master code in step 3. The keypad will then emit a single tone, indicating that the User code has been deleted.

### Important:

- Instruct other users to enter their codes carefully to avoid accidentally entering the Duress code, or, if desired, assign other users a code ending in "9" to prevent accidental duress code entry.
- Temporary Users should not be shown how to use any system function they do not need to know (example, bypassing protection points).
- Be sure user codes do not conflict with any Duress code.

# CHECKING FOR OPEN ZONES

**\* READY Key**

*Before arming your system, all protected doors, windows and other protection zones must be closed or bypassed (see BYPASSING section), otherwise the keypad will display a "Not Ready" message.*

Press the **READY \*** key (do not enter code first).

The keypad will display all zones that are faulted (see typical open zone display at right), making it easier for you to secure any open zones.

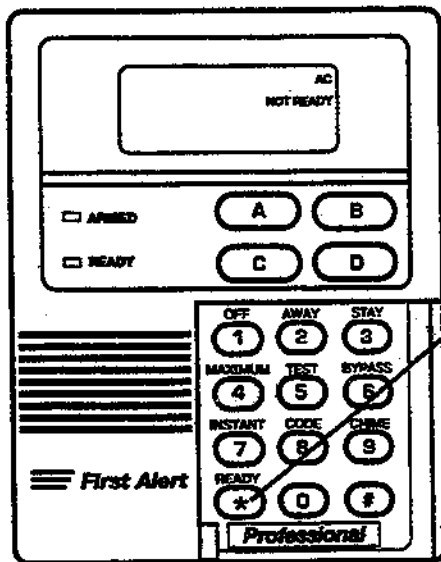

PRESS  
READY [\*]  
KEY TO  
DISPLAY  
OPEN ZONES

STYLE "B" KEYPAD SHOWN ABOVE  
(SAME KEY FUNCTION ON STYLE "A" KEYPAD)

**TYPICAL DISPLAY OF OPEN ZONE  
AFTER PRESSING THE [\*] KEY**

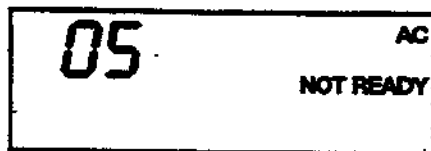

**TYPICAL "READY" MESSAGE  
WHEN ALL ZONES ARE SECURED**

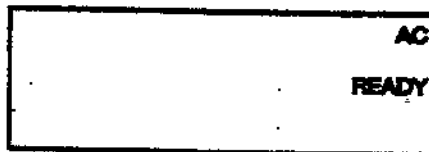

# BYPASSING PROTECTION ZONES

Using the

**6** **BYPASS Key**

*Single-digit zone numbers must be preceded by a zero (e.g., enter 01 for zone 1).*

**Limitations:**  
*The system will not allow fire or emergency zones to be bypassed.  
Arming the system before bypassed zones are displayed eliminates all bypasses.*

*All bypasses are removed when an OFF sequence (security code plus OFF) is performed.*

This key is used when you want to arm your system with one or more zones intentionally unprotected. The system must be disarmed first.

1. Enter your **security code** and press the **BYPASS** key.
2. Enter zone number(s) for the zones to be bypassed (e.g. 01, 02, etc.).
3. When finished, the keypad will display the word **BYPASS** and along with each bypassed zone number. Wait for these zones to be displayed before arming.
4. Arm the system as usual. Bypassed zones are unprotected and will not cause an alarm when violated while your system is armed.

## **Displaying Bypassed Protection Zones:**

1. Enter your **security code** and press the **BYPASS** key.
2. Wait for all bypassed protection zones to be sequentially displayed.
3. Bypassed zones can be displayed whether the system is armed or disarmed.



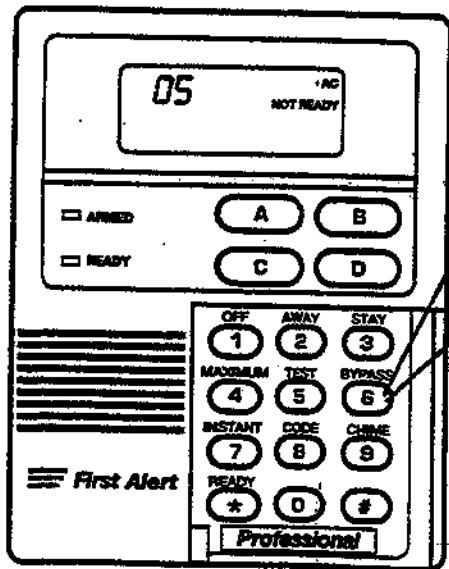

STYLE "B" KEYPAD SHOWN ABOVE  
(SAME KEY FUNCTION ON STYLE "A" KEYPAD)

TO BYPASS ZONE(S)  
ENTER SECURITY CODE,  
ENTER ZONE # (S) TO BE  
BYPASSES, AND PRESS  
BYPASS KEY

TO DISPLAY BYPASSED  
ZONES, ENTER  
SECURITY CODE AND  
PRESS BYPASS KEY

**TYPICAL KEYPAD DISPLAY AFTER  
"BYPASS" PROCEDURE**



**TYPICAL MESSAGE WHEN BYPASSED  
PROTECTION ZONES ARE DISPLAYED**

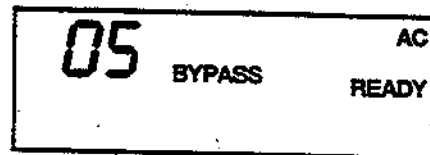

# ARMING PERIMETER ONLY

WITH ENTRY DELAY ON

Using the

3

**STAY Key**

Use this key when you are staying home, but might expect someone to use an entry/exit door later.

*Close all perimeter windows and doors before arming. Your system will not arm if any zone is open (see CHECKING FOR OPEN ZONES on a previous page).*

1. Enter your **security code** and press the **STAY** key.
2. The keypad will emit three tones and display the armed message shown at the right.
3. The system is now armed. You may move freely throughout the house, but if a perimeter door or window is opened, an alarm sounds. Late arrivals can enter through an entry/exit door without causing an alarm, but they must disarm the system within the entry delay period.

# ARMING PERIMETER ONLY

WITH ENTRY DELAY ON

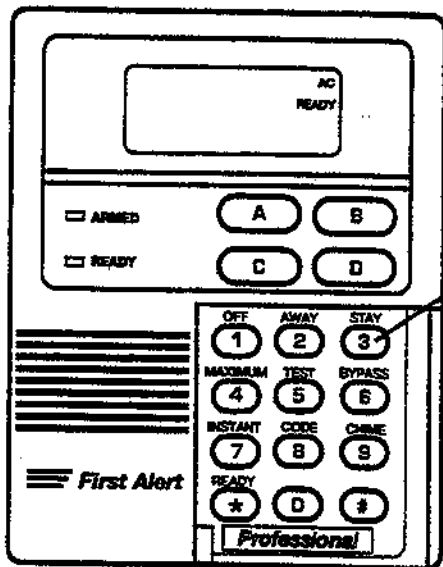

ENTER  
SECURITY  
CODE  
AND PRESS  
STAY KEY

TYPICAL KEYPAD DISPLAY WHEN  
THE SYSTEM HAS BEEN "ARMED STAY"



STYLE "B" KEYPAD SHOWN ABOVE  
(SAME KEY FUNCTION ON STYLE "A" KEYPAD)

# ARMING PERIMETER ONLY

WITH ENTRY DELAY OF

## 7 Using the INSTANT Key

*Close all perimeter windows and doors before arming. Your system will not arm if any zone is open (see CHECKING FOR OPEN ZONES on a previous page).*

Use this key when you are staying home and do not expect anyone to use an entry/exit door.

1. Enter your **security code** and press the **INSTANT** key.
2. The keypad will emit three tones and display the armed message.
3. The system is now armed. You may move freely throughout the house, but if a perimeter door or window is opened, an alarm sounds. The alarm also sounds immediately if anyone opens an entry/exit door.

**ARMING PERIMETER ONLY**  
*WITH ENTRY DELAY OFF*

TYPICAL KEYPAD DISPLAY WHEN  
THE SYSTEM HAS BEEN "ARMED INSTANT"

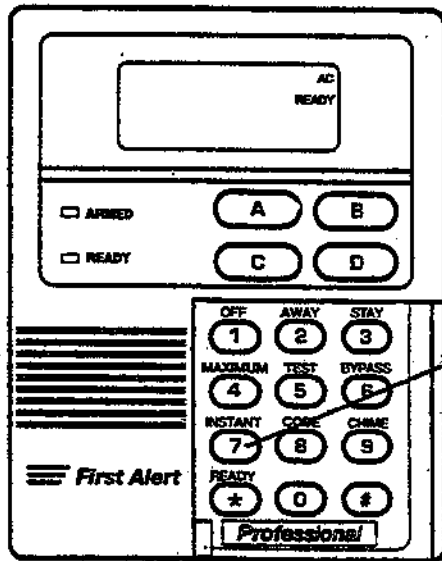

ENTER  
SECURITY  
CODE  
AND PRESS  
INSTANT KEY

STYLE "B" KEYPAD SHOWN ABOVE  
(SAME KEY FUNCTION ON STYLE "A" KEYPAD)

# ARMING ALL PROTECTION

WITH ENTRY DELAY

Using the

**2** AWAY Key

Use this key when no one will be staying home.

1. Enter your **security code** and press the **AWAY** key.
2. The keypad will emit two tones and display the armed message.
3. The system is now armed. If a protected door or window is opened, or if movement is detected inside your house by motion detectors used in your system, an alarm sounds.

You may leave through an entry/exit door during the exit delay period without causing an alarm. You may also re-enter through an entry/exit door, but must disarm the system within the entry delay period.

*All windows and doors should be closed so that the "Ready" message is displayed. Your system will not arm if any zone is open (see CHECKING FOR OPEN ZONES previously).*

# ARMING ALL PROTECTION

WITH ENTRY DELAY ON

TYPICAL KEYPAD DISPLAY WHEN  
THE SYSTEM HAS BEEN "ARMED AWAY"

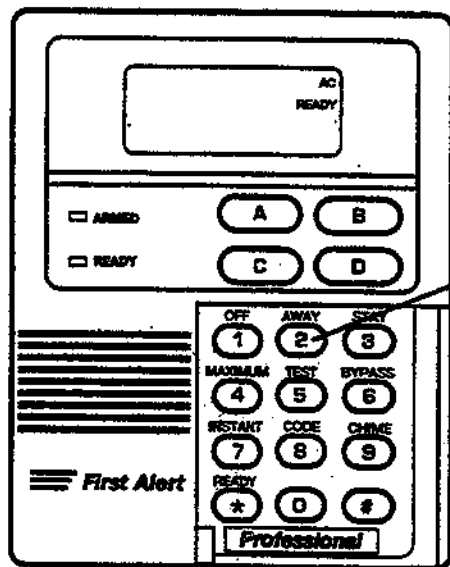

ENTER  
SECURITY  
CODE  
AND PRESS  
AWAY KEY

STYLE "B" KEYPAD SHOWN ABOVE  
(SAME KEY FUNCTION ON STYLE "A" KEYPAD)

# ARMING ALL PROTECTION

WITH ENTRY DELAY OFF

## Using the

### 4 MAXIMUM Key

All windows and doors should be closed so that the "Ready" message is displayed. Your system will not arm if any zone is open (see CHECKING FOR OPEN ZONES previously).

Use this key when the premises will be vacant for extended periods of time such as vacations, etc., or when retiring for the night and no one will be moving through protected interior areas.

1. Enter your **security code** and press the **MAXIMUM** key.
2. The keypad will emit two tones and will display the armed message.
3. The system is now armed. If a protected door or window is opened, or if movement is detected inside your house by motion detectors used in your system, an alarm sounds.

You may leave through an entry/exit door during the exit delay period without causing an alarm, but an alarm sounds as soon as someone re-enters.



# ARMING ALL PROTECTION

WITH ENTRY DELAY OFF

TYPICAL KEYPAD DISPLAY WHEN  
THE SYSTEM HAS BEEN "ARMED MAXIMUM"

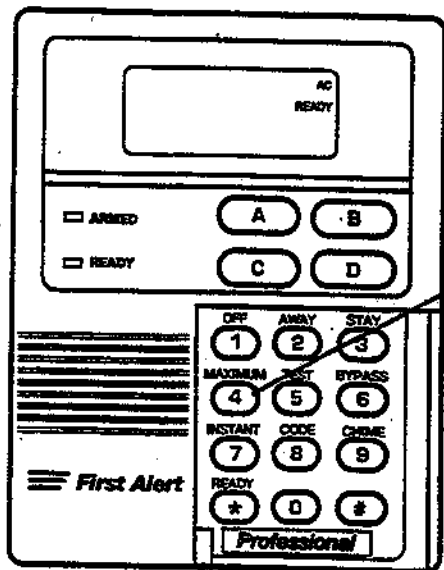

ENTER  
SECURITY  
CODE  
AND PRESS  
MAXIMUM KEY

STYLE "B" KEYPAD SHOWN ABOVE  
(SAME KEY FUNCTION ON STYLE "A" KEYPAD)

# DISARMING THE SYSTEM AND SILENCING ALARMS

Using the

**1 OFF Key**

The OFF key is used to disarm the system and to silence alarm and trouble sounds.

**To disarm the system and silence burglary or fire alarms:**

1. Enter your **security code** and press the **OFF** key.

The "Ready" message will be displayed, and the keypad will emit a single tone to confirm that the system is disarmed.

See *SUMMARY OF AUDIBLE SOUNDS AND DISPLAYS* section for information which will help you to distinguish between FIRE and BURGLARY alarm sounds.

2. If a burglary alarm has occurred, and the premises is safe to re-enter, note the zone number displayed on the keypad and repeat step 1 to restore the "Ready" message display (to clear the "Memory of Alarm"). If the "Ready" message will not display, go to the displayed zone and remedy the fault (close windows, etc.). If the fault cannot be remedied, notify the alarm agency.

## **IMPORTANT:**

*If you return and the burglary alarm is sounding, DO NOT ENTER THE PREMISES, but call the police from a nearby safe location. If you return after an alarm has occurred and the main sounder has shut itself off, the keypad will emit rapid tones upon entering, indicating that an alarm has occurred during your absence. LEAVE AT ONCE and CONTACT THE POLICE from a nearby safe location.*

# CHIME MODE

9

## Using the CHIME Key

Your system can be set to alert you to the opening of a door or window while it is disarmed by using CHIME mode. When Chime is on, three tones will sound at the Keypad whenever a door or window is opened. Pressing the **READY** [\*] key will display the open protection points.

**This feature can be used only when the burglary system is disarmed.**

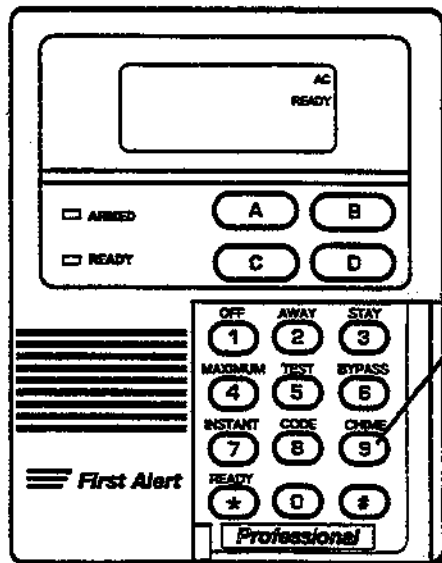

### To turn Chime Mode on:

Enter the **security code** and press the **CHIME** key.

### To turn Chime Mode off:

Enter the **security code** and press the **CHIME** key again. The CHIME message will disappear.

### TYPICAL "CHIME ON" DISPLAY



STYLE "B" KEYPAD SHOWN ABOVE  
(SAME KEY FUNCTION ON STYLE "A" KEYPAD)

## **DURESS CODE**

### **(WHEN FORCED TO DISARM/ARM UNDER THREAT)**

#### **Using the Duress Code**

Enter the first three (or 5\*) digits of the security code. Increase the final digit by one and then press **OFF** (or **AWAY**, etc., if arming the system). The system will disarm (or arm), but can silently notify the central station of your situation, if that service has been provided.

\* If a 6-digit security code is used in your system.

#### *Example:*

Normal security code is "1 2 3 4"

Duress security code is "1 2 3 5".

#### *Important*

- This code is useful only when connected to a central station.
- Duress code capability is not present for codes ending in 9.
- Users of temporary codes must be instructed to enter their codes carefully to avoid the possibility of accidentally entering the Duress code.

## Using Panic Keys

To use a Panic function, simply press both keys of the assigned pair at the same time (or press key B or C, if present) and hold down for at least two seconds.

# PANIC (EMERGENCY) KEYS

Your system may have been programmed to use individual keys or special key combinations to manually activate panic (emergency) functions. The functions that might be programmed are Silent Emergency, Audible Emergency, Personal Emergency, and Fire.

### Active Panic Functions

(Your installer should note below which functions are active in your system)

Keys	Function
A*	NOT USED
B*	
C*	
D*	NOT USED
* and #	
3 and #	

\* Individual Panic Keys A, B, C, & D not present on all consoles.

Key B (or \* and #) displayed as zone 99.†

Key C (or 3 and #) displayed as zone 96.†

† Unless programmed for silent emergency, in which case there will be no display.

**A silent emergency**, sends a silent alarm signal to the central station, but there will be no audible alarms or visual displays.

**An audible emergency**, sounds a loud, steady alarm at your console and at any external sounders that may be connected (**ALARM** plus a zone number would also be displayed).

**A personal emergency alarm** sends an emergency message to the central station (if connected) and will sound at consoles, but not at external bells or sirens.

**A fire alarm** sends a fire alarm message to the central station and will uniquely sound external bells and sirens (**FIRE** plus a zone number would also be displayed).

# TESTING THE SYSTEM

---

## TO BE CONDUCTED WEEKLY

### Testing Your System

*Note that no alarm reports will be sent to the central monitoring station while the system is in the Test mode.*

*The Keypad will sound a single tone at 15-second intervals (if no protection points are violated), as a reminder that the system is in the Test mode.*

The Test key puts your system into the Test mode, which allows each protection point to be checked for proper operation.

1. Disarm the system and close all protected windows, doors, etc. The "Ready" message should be displayed.
2. Enter your **security code** and press the **TEST** key.
3. The external sounder should sound for 3 seconds and then turn off. If the sounder fails to sound, it may be due to one of the following:
  - a) Dialer communication activity (keypads will display **CC**). Wait a few minutes for the display to clear and try again. If the sounder still fails to sound, **CALL FOR SERVICE**.
  - b) The system's back-up battery may be too weak to activate the external sounder (keypads will display **BAT with no ID number**). This may be due to discharge of the back-up battery caused by activation of the external siren or bell for an extended period during a recent alarm. If so, allow at least 8 hours for the battery to re-charge before testing again.
4. Immediately after the sounder turns off, the system enters the Test mode, which allows each protection point to be checked for proper operation.
5. **Doors and Windows:** Open and close each protected door and window in turn. Each action should produce 3 tones. The zone identification number of each faulted protection point should also be displayed. Your installer should have indicated (on page 39) the location/description for each of the active zone numbers in your system.

---

## TESTING THE SYSTEM

6. **Motion Detectors:** Walk in front of any interior motion detectors (if used) and listen for 3 tones as movement is detected. The identification of the detector should also be displayed when the motion detector is activated.
7. **Smoke Detectors:** Follow the manufacturer's instructions to test all smoke detectors to ensure that all are functioning properly. The identification of each detector should also be displayed when each is activated.
8. When all protection points have been checked, there should be no zone identification numbers displayed. If a problem is experienced with any protection point (no confirming sounds, no display), **CALL FOR SERVICE**.
9. **Turn off the Test mode** by entering the security code and pressing the **OFF** key.

# TROUBLE CONDITIONS

---

## **"CHECK" Displays**

If the word **CHECK** appears on the keypad's display, accompanied by rapid tones at the keypad, it indicates a trouble condition in the system. The audible warning sounds may be silenced by pressing any key.

*A display of "CHECK", accompanied by a numeric display of one or more zone numbers (displayed sequentially):* This indicates that a problem exists with those zones being displayed.

First, determine if the zone(s) displayed are intact and make them so if they are not. If the display of the zone number(s) and CHECK does not clear, key an OFF sequence (Code plus OFF). If the display persists, **CALL FOR SERVICE IMMEDIATELY.**

## **Other Trouble Conditions**

1. *A display of CC:* This indicates that the system is in communication with the alarm monitoring station for change of function or status verification. If this display remains on for more than 10 minutes, call your service company.
2. *A display of FC in the numeric display area:* This indicates that a failure has occurred in the telephone communication portion of your system, which means that your system is not able to send messages to your alarm monitoring station. **CALL FOR SERVICE IMMEDIATELY.**



---

## TROUBLE CONDITIONS

3. *A display of **BAT** and no ID number, accompanied by a single tone every 60 seconds at the keypad:* This indicates that the system back-up battery has a low battery condition. If there is no apparent cause for this (such as AC power having been cut off for an extended period, or an alarm having caused the external sounder to be activated for a long period), **CALL FOR SERVICE.**

### **Power Failure**

If AC power to the system is cut off, the message "**NO AC**" is displayed, and the Keypad is operating on battery power only.

On keypads with a **POWER** indicator, if AC power to the system is off, this indicator will be off.

If only some lights are out on the premises, check circuit breakers and fuses and reset or replace as necessary. **CALL FOR SERVICE** if AC power cannot be restored.

# FIRE ALARM SYSTEM

**IF INSTALLED**

## **General**

Your fire alarm system (if installed) is on 24 hours a day, for continuous protection. In the event of an emergency, smoke and heat detectors signal your system, triggering a loud, interrupted alarm sound from the Keypad. An interrupted sound is also produced by optional exterior sounders. A FIRE message will appear at your Keypad and remain displayed until you silence the alarm.

## **In Case Of Fire Alarm**

1. Should you become aware of a fire emergency before your detectors sense the problem, go to your nearest Keypad and manually initiate an alarm by pressing individual panic keys **B** or **C**, or panic key pairs \* & # or 3 & # (if present) assigned as FIRE emergency\* and hold down for at least 2 seconds.  
\* If programmed by the installer – see page 29.
2. Evacuate all occupants from the premises.
3. If flames and/or smoke are present, leave the premises and notify your local Fire Department immediately.
4. If no flames or smoke are apparent, investigate the cause of the alarm. The zone number(s) of the zone(s) in an alarm condition will be displayed at the Keypad.



**Typical Fire Emergency Display**

---

# FIRE ALARM SYSTEM

## *IF INSTALLED*

### **Silencing Fire Alarms**

1. Silence the alarm by entering your **security code** and pressing the **OFF** key. To clear the display, enter your code and press the **OFF** key again (clears Memory of Alarm).
2. If the Keypad does not indicate a "READY" condition after the second OFF sequence, press the **READY** key to display the zone(s) that are faulted. Be sure to check that smoke detectors are not responding to smoke or heat-producing objects in their vicinity. Should this be the case, eliminate the source of heat or smoke.
3. If this does not remedy the problem, there may still be smoke in the detector. Clear it by fanning the detector for about 30 seconds.
4. When the problem has been corrected, clear the display by entering your code and pressing the **OFF** key.

# NATIONAL FIRE PROTECTION ASSOCIATION RECOMMENDATIONS ON SMOKE DETECTORS

**General** With regard to the number and placement of smoke/heat detectors, we subscribe to the recommendations contained in the National Fire Protection Association's Standard #74 noted below.

Early warning fire detection is best achieved by the installation of fire detection equipment in all rooms and areas of the household as follows: A smoke detector installed outside of each separate sleeping area, in the immediate vicinity of the bedrooms and on each additional story of the family living unit, including basements and excluding crawl spaces and unfinished attics.

In addition, it is recommended that the householder consider the use of heat or smoke detectors in the living room, dining room, bedroom(s), kitchen, hallway(s), attic, furnace room, utility and storage rooms, basements and attached garages.

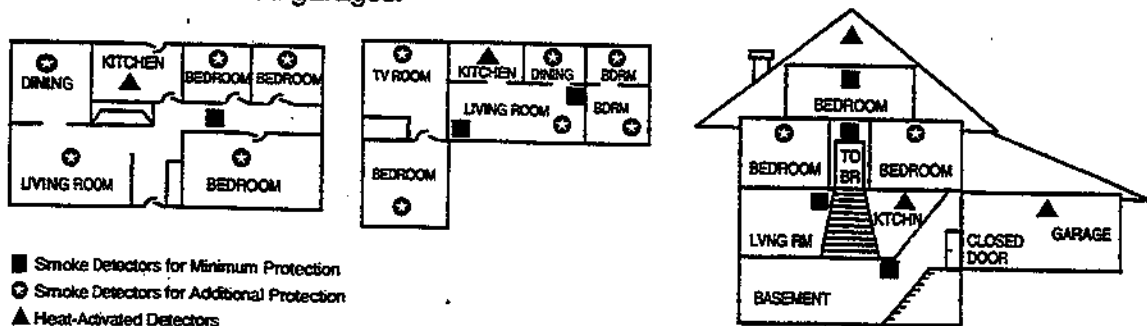

# EMERGENCY EVACUATION

## Steps to Safety

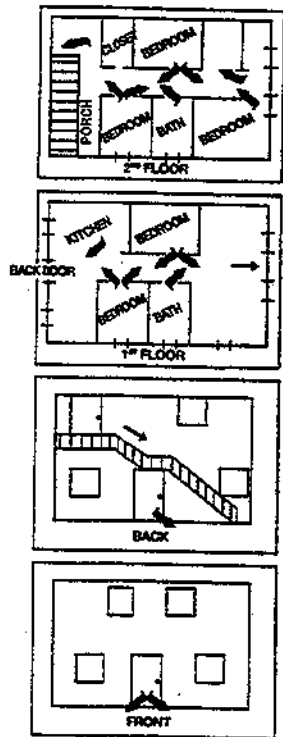

Establish and regularly practice a plan of escape in the event of fire. The following steps are recommended by the National Fire Protection Association:

1. Plan on your detector or your interior and/or exterior sounders warning all occupants.
2. Determine two means of escape from each room. One path of escape should lead to the door that permits normal exit from the building. The other may be a window, should your path be unpassable. Station an escape ladder at such windows if there is a long drop to the ground.
3. Sketch a floor plan of the building. Show windows, doors, stairs and rooftops that can be used to escape. Indicate escape routes for each room. Keep these routes free from obstruction and post copies of the escape routes in every room.
4. Assure that all bedroom doors are shut while you are asleep. This will prevent deadly smoke from entering while you escape.
5. Try the door. If the door is hot, check your alternate escape route. If the door is cool, open it cautiously. Be prepared to slam the door if smoke or heat rushes in.
6. Keep close to the floor – smoke and hot gases rise. Breathe through a cloth (wet, if possible) and take short, shallow breaths.
7. Escape quickly; don't panic.
8. Establish a common meeting place outdoors, away from your house, where everyone can meet and then take steps to contact the authorities and account for those missing. Choose someone to assure that nobody returns to the house — many die going back.

## SUMMARY OF AUDIBLE SOUNDS & DISPLAYS

SOUND	CAUSE	KEYPAD DISPLAY
LOUD, INTERRUPTED* (Keypad & External)	FIRE ALARM	FIRE and ALARM is displayed; protection zone in alarm is also displayed.
LOUD, CONTINUOUS* Keypad & External	BURGLARY/AUDIBLE EMERGENCY ALARM	ALARM is displayed; protection zone in alarm is also displayed.
ONE SHORT TONE (not repeated)	a. SYSTEM DISARM b. SYSTEM ARMING ATTEMPT WITH AN OPEN ZONE. c. BYPASS VERIFY	a. Only READY is displayed. b. NOT READY is displayed, open protection zone number is also displayed. c. The bypassed protection zone numbers are displayed (one tone for each number displayed). BYPASS also displayed.
ONE SHORT TONE (once every 60 secs.)	a. SYSTEM IS IN TEST MODE b. SYSTEM BATTERY LOW	a. Opened zone numbers will appear. b. BAT displayed with no ID number
TWO SHORT TONES	ARM AWAY OR MAXIMUM	AWAY and possibly INSTANT are displayed.
THREE SHORT TONES	a. ARM STAY OR INSTANT b. ZONE OPENED WITH SYSTEM IN CHIME MODE. c. ENTRY WARNING**	a. STAY and possibly INSTANT are displayed b. CHIME displayed, open protection zone number is displayed . c. No display.
RAPID TONES	a. TROUBLE b. AC POWER LOSS ALERT c. MEMORY OF ALARM	a. CHECK displayed. Troubled protection zone is displayed. b. NO AC displayed (alternated with other displays, if present). c. FIRE and/or ALARM is displayed; zone in alarm is displayed.
SLOW TONES	a. ENTRY DELAY WARNING  b. EXIT DELAY WARNING	a. None during delay; exceeding the delay time without disarming causes alarm. b. Normal armed AWAY, STAY, or INSTANT display.

\* If bell is used as external sounder, fire alarm is pulsed ring; burglary/audible emergency is steady ring.

# PROTECTION ZONES

## General Information

One or more sensing devices will have been assigned by the installer to each of the various protection zones in your system (although not every zone may have been used). For example, the sensing device on your Entry/Exit door may have been assigned to zone 01, sensing devices on windows in the master bedroom to zone 02, and so on. The following chart has been provided for your convenience. Your installer will assist you in recording the information.

ID numbers 01-08 represent sensor/detector protection points. ID numbers 96 or 99 represent "Panic" alarm codes (see below). Other ID numbers may appear when certain system problems are present (see *TROUBLE CONDITIONS* on previous pages).

### PROTECTION POINT DESCRIPTIONS

Zone	Location/Description
01	_____
02	_____
03	_____
04	_____
05	_____
06	_____
07	_____
08	_____

Other numeric displays may also appear on your keypad:

<i>Display</i>	<i>Meaning</i>
----------------	----------------

96*	_____
-----	-------

99*	_____
-----	-------

\* May be displayed when Emergency keys are pressed (see PANIC section).

## QUICK REFERENCE OPERATING GUIDE

FOR THIS FUNCTION	PRESS THESE KEYS	Comments
DISPLAYING OPEN ZONES	[*] Key	Open zone(s) will be (System disarmed) displayed
PERIMETER PROTECTION (with entry delay)	Security Code + STAY [3]	Interior unarmed for freedom of movement inside. Entry and exit delay in effect.
PERIMETER PROTECTION (with no entry delay)	Security Code + INSTANT [7]	Interior unarmed for freedom of movement inside. Exit delay is in effect.
FULL PROTECTION PERIMETER & INTERIOR	Security Code + AWAY [2]	Perimeter and interior protected. Exit delay is (with entry delay) in effect.
FULL PROTECTION PERIMETER & INTERIOR	Security Code + MAXIMUM [4]	Perimeter and interior protected. Exit delay is (with no entry delay) in effect.
DISARMING SYSTEM (and silencing alarms)	Security Code + OFF [1]	System is disarmed and any alarms silenced.
BYPASSING PROTECTION ZONES	Security Code + BYPASS [6] + Zone number (01, 02, etc.)	Zones bypassed will be unprotected.
INITIATING EMERGENCY ALARMS	Key pairs * & # or key B Key pairs # & 3 or key C	Press keys (or key) assigned for the desired emergency alarm (silent, audible, or fire)
ADDING A TEMPORARY USER CODE DELETING A TEMPORARY CODE	Master Security Code + CODE [8] + User # + Temporary Code Master Security Code + CODE [8] + User # to be deleted + Master Code	Temporary code can be used to perform system commands until that code is deleted.
ENTERING CHIME MODE EXITING CHIME MODE	Security Code + CHIME [9] Security Code + CHIME [9] again	Opening or closing any protected window, door, etc. will produce 3 tones when the system is in the Chime mode.
ENTERING TEST MODE EXITING TEST MODE	Security Code + TEST [5] Security Code + OFF [1]	External sounder (if used) will sound for 3 seconds. In Test mode, opening or closing any window, door, etc. will cause 3 tones.



## MAINTAINING YOUR SYSTEM

### Taking Care of Your System

The components of your security system are designed to be as free of maintenance as possible. However, there are some things you can do to make sure that your system is in reliable working condition.

1. Test your system weekly.
2. Test the system soon after any alarm occurs (see *TESTING THE SYSTEM*).

### Routine Care

- Treat the components of your security system as you would any other electrical equipment. Do not slam sensor-protected doors or windows.
- Keep dust from accumulating on the keypad and all protective sensors, particularly on motion sensors and smoke detectors.
- The keypad and sensors should be cleaned carefully with a dry soft cloth. *Do not spray water or any other fluid on the units.*

### **FEDERAL COMMUNICATIONS COMMISSION (FCC) PART 15 STATEMENT**

This equipment has been tested to FCC requirements and has been found acceptable for use. The FCC requires the following statement for your information:

This equipment generates and uses radio frequency energy and if not installed and used properly, that is, in strict accordance with the manufacturer's instructions, may cause interference to radio and television reception. It has been type tested and found to comply with the limits for a Class B computing device in accordance with the specifications in Part 15 of FCC Rules, which are designed to provide reasonable protection against such interference in a residential installation. However, there is no guarantee that interference will not occur in a particular installation. If this equipment does cause interference to radio or television reception, which can be determined by turning the equipment off and on, the user is encouraged to try to correct the interference by one or more of the following measures:

- If using an indoor antenna, have a quality outdoor antenna installed.
- Reorient the receiving antenna until interference is reduced or eliminated.
- Move the receiver away from the control/communicator.
- Move the antenna leads away from any wire runs to the control/communicator.
- Plug the control/communicator into a different outlet so that it and the receiver are on different branch circuits.

If necessary, the user should consult the dealer or an experienced radio/television technician for additional suggestions.

The user or installer may find the following booklet prepared by the Federal Communications Commission helpful: "Interference Handbook"

This booklet is available from the U.S. Government Printing Office, Washington, DC 20402.

The user shall not make any changes or modifications to the equipment unless authorized by the Installation Instructions or User's Manual. Unauthorized changes or modifications could void the user's authority to operate the equipment.

**UL NOTICE: This is a "Grade A" Residential System.**

### FEDERAL COMMUNICATIONS COMMISSION (FCC) PART 68 NOTICE

This equipment complies with Part 68 of the FCC rules. On the front cover of this equipment is a label that contains, among other information, the FCC registration number and ringer equivalence number (REN) for this equipment. If requested, this information must be provided to the telephone company.

This equipment uses the following jacks:

An RJ31X is used to connect this equipment to the telephone network.

The REN is used to determine the quantity of devices which may be connected to the telephone line. Excessive RENs on the telephone line may result in the devices not ringing in response to an incoming call. In most, but not all areas, the sum of the RENs should not exceed five (5.0). To be certain of the number of devices that may be connected to the line, as determined by the total RENs, contact the telephone company to determine the maximum REN for the calling area.

If this equipment causes harm to the telephone network, the telephone company will notify you in advance that temporary discontinuance of service may be required. If advance notice is not practical, the telephone company will notify the customer as soon as possible. Also, you will be advised of your right to file a complaint with the FCC if you believe necessary.

The telephone company may make changes in its facilities, equipment, operations, or procedures that could affect the operation of the equipment. If this happens, the telephone company will provide advance notice in order for you to make the necessary modifications in order to maintain uninterrupted service.

If trouble is experienced with this equipment, please contact the manufacturer for repair and warranty information. If the trouble is causing harm to the telephone network, the telephone company may request you remove the equipment from the network until the problem is resolved.

There are no user serviceable components in this product, and all necessary repairs must be made by the manufacturer. Other repair methods may invalidate the FCC registration on this product.

This equipment cannot be used on telephone company-provided coin service. Connection to Party Line Service is subject to state tariffs.

This equipment is hearing-aid compatible.

When programming or making test calls to an emergency number, briefly explain to the dispatcher the reason for the call. Perform such activities in the off-peak hours; such as early morning or late evening.

# CANADIAN DEPARTMENT OF COMMUNICATIONS (DOC) STATEMENT

## NOTICE

The Canadian Department of Communications label identifies certified equipment. This certification means that the equipment meets certain telecommunications network protective, operational and safety requirements. The Department does not guarantee the equipment will operate to the user's satisfaction.

Before installing this equipment, users should ensure that it is permissible to be connected to the facilities of the local telecommunications company. The equipment must also be installed using an acceptable method of connection. In some cases, the company's inside wiring associated with a single line individual service may be extended by means of certified connector assembly (telephone extension cord). The customer should be aware that compliance with the above conditions may not prevent degradation of service in some situations.

Repairs to certified equipment should be made by an authorized Canadian maintenance facility designated by the supplier. Any repairs or alterations made by the user to this equipment, or equipment malfunctions, may give the telecommunications company cause to request the user to disconnect the equipment.

Users should ensure for their own protection that the electrical ground connections of the power utility, telephone lines and internal metallic water pipe system, if present, are connected together. This precaution may be particularly important in rural areas.

**Caution:** User should not attempt to make such connections themselves, but should contact the appropriate electric inspection authority, or electrician, as appropriate.

The Load Number (LN) assigned to each terminal device denotes the percentage of the total load to be connected to a telephone loop which is used by the device, to prevent overloading. The termination on a loop may consist of any combination of devices subject only to the requirement that the total of the Load Numbers of all the devices does not exceed 100.

## AVIS

L'étiquette du ministère des Communications du Canada identifie le matériel homologué. Cette étiquette certifie que le matériel est conforme à certaines normes de protection, d'exploitation et de sécurité des réseaux de télécommunications. Le ministère n'assure

toutefois pas que le matériel fonctionnera à la satisfaction de l'utilisateur.

Avant d'installer ce matériel, l'utilisateur doit s'assurer qu'il est permis de le raccorder aux installations de l'entreprise locale de télécommunications. Le matériel doit également être installé en suivant une méthode acceptée de raccordement. Dans certains cas, les fils intérieurs de l'entreprise utilisés pour un service individuel à la ligne unique peuvent être prolongés au moyen d'un dispositif homologué de raccordement (cordon prolongateur téléphonique interne). L'abonné ne doit pas oublier qu'il est possible que la conformité aux conditions énoncées ci-dessus n'empêche pas la dégradation du service dans certaines situations. Actuellement, les entreprises de télécommunications ne permettent pas que l'on raccorde leur matériel aux prises d'abonnés, sauf dans les cas précis prévus par les tarifs particuliers de ces entreprises.

Les réparations du matériel homologué doivent être effectuées pas un centre d'entretien canadien autorisé désigné par le fournisseur. La compagnie de télécommunications peut demander à l'utilisateur de débrancher un appareil à la suite de réparations ou de modifications effectuées par l'utilisateur ou à cause de mauvais fonctionnement.

Pour sa propre protection, l'utilisateur doit s'assurer que tous les fils de mise en terre de la source d'énergie électrique, des lignes téléphoniques de réseau de conduites d'eau s'il y en a, soient raccordés ensemble. Cette précaution est particulièrement importante dans les régions rurales.

**Avertissement:** L'utilisateur ne doit pas tenter de faire ces raccordements lui-même; il doit avoir recours à un service d'inspection des installations électriques, ou à un électricien, selon le cas.

L'indice de charge (IC) assigné à chaque dispositif terminal pour éviter toute surcharge indique le pourcentage de la charge totale qui peut être raccordé à un circuit téléphonique bouclé utilisé par ce dispositif. La terminaison du circuit bouclé peut être constituée de n'importe quelle combinaison de dispositifs, pourvu que la somme des indices de charge de l'ensemble des dispositifs ne dépasse pas 100.

## OWNER'S INSURANCE PREMIUM CREDIT REQUEST

This form should be completed and forwarded to your homeowner's insurance carrier for possible premium credit.

### A. GENERAL INFORMATION:

Insured's Name and Address: \_\_\_\_\_  
\_\_\_\_\_

Insurance Company: \_\_\_\_\_ Policy No.: \_\_\_\_\_

**Model: First Alert FA200C**

Type of Alarm:  Burglary  Fire  Both

Installed by: \_\_\_\_\_ Serviced by: \_\_\_\_\_  
Name Name  
Address Address

### B. NOTIFIES (Insert B = Burglary, F = Fire)

Local Sounding Device \_\_\_\_\_ Police Dept. \_\_\_\_\_ Fire Dept. \_\_\_\_\_

Central Station  Name: \_\_\_\_\_  
Address: \_\_\_\_\_  
Phone: \_\_\_\_\_

**C. POWERED BY: A.C. With Rechargeable Back-up Battery Power Supply**

*(Continued on other side)*

## OWNER'S INSURANCE PREMIUM CREDIT REQUEST (cont.)

D. TESTING:  Quarterly     Monthly     Weekly     Other \_\_\_\_\_

### E. SMOKE DETECTOR LOCATIONS

Furnace Room     Kitchen     Bedrooms     Attic  
 Basement     Living Room     Dining Room     Hall

### F. BURGLARY DETECTING DEVICE LOCATIONS:

Front Door     Basement Door     Rear Door     All Exterior Doors  
 1st Floor Windows     All Windows     Interior Locations  
 All Accessible Openings, Including Skylights, Air Conditioners and Vents

### G. ADDITIONAL PERTINENT INFORMATION:

---

---

---

Signature: \_\_\_\_\_

Date: \_\_\_\_\_